

# Push-pull Connectors

Part No: 2BRGGD12CLAD92Z



[www.rlcables.com](http://www.rlcables.com)

2B Series 12-Cores , Straight plug , Sheath type



## Technical parameter

Mechanical Properties	
Shell style	Straight plug
Sheating material	Brass shell and collet nut , nickel plated. Brass latch sleeve and mid pieces
Colour	Grey
Locking method	Push-pull
Plug-and-play count	>5000 times
Temperature range	-55° C / +250° C
Water resistance level	IP50
Adapter cable	8.30 - 9.20mm

Electric properties	
Internal components	12 Pins
Conductor Structure	Brass gold plated
Insulation	Peek
Conductor diameter	0.7 mm
Salt spray test	>144Hr
Maximum contact resistance	6.1 mOhm
Rated current	7 A
Test voltage ( Contact - Shell )	2 KV(DC)

# Push-pull Connectors

Part No: 2BRGGD12CLAD92Z



[www.rlcables.com](http://www.rlcables.com)

Drawing

Insert Configuration  
Rear View

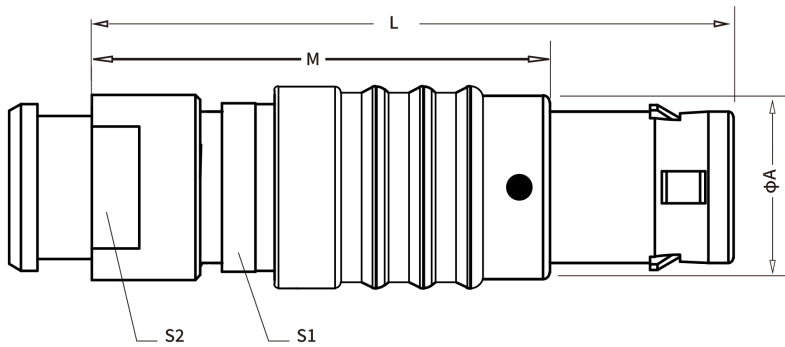

Size (mm)				
A	L	M	S1	S2
15.0	49.0	37.0	13.0	12.0